



# LED Slim Panel Light – Color tunable version



SC-DL09-Y04-A1-01RE  
SC-DL12-Y06-A1-01RE



## Description

LED round panel light can perfect replace traditional downlight. Low light pollution, excellent protection from eyestrain.

## Features

- 1.CCT tunable from 2700K-3000K-4000K or 3000K-4000K-5000K;
- 2.The diffuser plate adopt double-sided frosted plate, more uniform light;
- 3.The frame adopt ADC12,better cooling effect; adopt low-power large LEDs, and LEDs work in low temperature;
- 4.Light guide plate adopt imported laser dot PMMA, high stability, high lighting effect, uniform luminous surface, no dark spot; long lifetime;
- 5.The back cover adopt bending, powder spraying; consistent whole effect, and prevent light-leaking;
- 6.The driver is designed with no flicker, and is dimmable with most regular dimmers, dimming range up to 10%-100%.

## Applications

Suitable for shop, supermarket, shopping mall, hospital, office, house, shopping mall, factory and other indoor places.





## Product data

Model	CCT	Luminous flux (±10%)	Power (W)	Cutout size ±2	Beam angle	IP code	Input Voltage	LED type and qty.	CRI	PF
SC-DL09-Y04-A1-01RE	2700K-3000K-4000K	600 lm	9W	Φ4.53"	110°	IP40	90-130VAC	2835	≥90	>0.9
SC-DL09-Y04-A1-02RE	3000K-4000K-5000K			Φ4.53"						
SC-DL12-Y06-A1-01RE	2700K-3000K-4000K	900 lm	12W	Φ6.30"						
SC-DL12-Y06-A1-02RE	3000K-4000K-5000K			Φ6.30"						
SC-DL12-Y06H-A1-01RE	2700K-3000K-4000K	1100 lm	12W	Φ6.30"						
SC-DL12-Y06H-A1-02RE	3000K-4000K-5000K			Φ6.30"						

## Dimension(Unit: inch)

### (1)LED round panel series

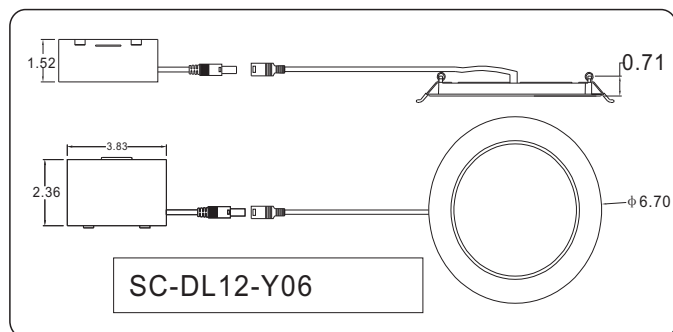
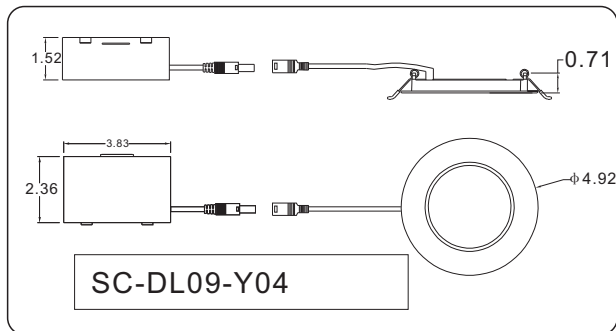

## Installation

1. Drill hole according model

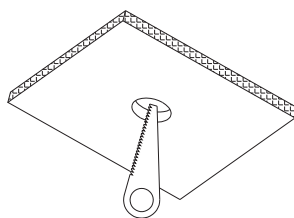

Note :Please check the hole size at model list table

2. Before installation, please slide the dip switch to the right color temperature at the back side of the panel light

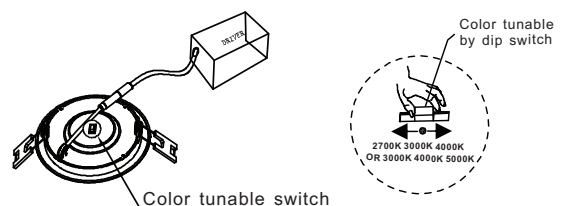



3. (1) Rotate right-handed with slotted screwdriver to remove the top cover
- (2) Open the side knockout of the junction box with slotted screwdriver

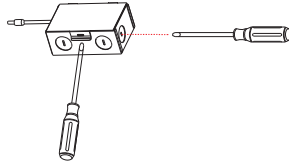

4. Wire connection  
White wire is connected to N; black wire is connected to L; and yellow wire is connected to G

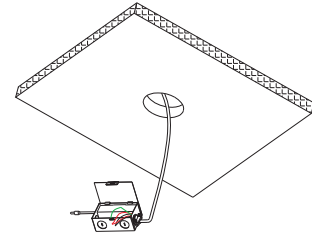

5. Embed the light into the hole of ceiling

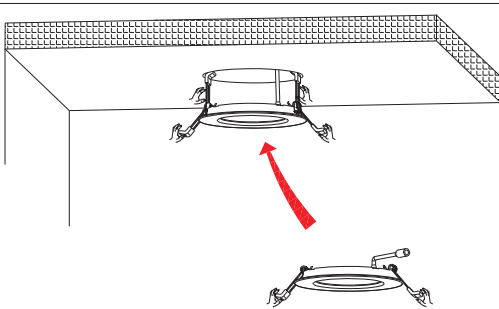

## Installation requirements

1. Power off before installation
2. Drill proper hole into the ceiling according to product model
3. Connect AC wire
4. Embed the light into ceiling hole
5. Light up and test; installation finish

## Packing information

Product size	Inner box (PCS)	Inner box size /inch	Weight of inner box	Outer carton (PCS)	Size of outer carton /inch	Weight of outer carton
4 inch round	1	8.20*6.02*1.77	Ross weight 0.21Kg/box	40	18.90*12.99*17.32	Gross weight 9.5Kg/carton
6 inch round	1	10.70*8.15*1.77	Ross weight 0.35Kg/box	30	27.76*9.25*22.24	Gross weight 12Kg/carton

## ! Notice

1. Please read the specification first, to make sure the service environment matches the condition in the specification before using;
2. Please confirm input voltage, frequency;
3. The light must be installed by professional;
4. If power wire or shell of the light is damaged, the light is unqualified and can't be used;
5. Dangerous high voltage, non-professionals are not allowed to maintain the products;
6. If the exterior soft cable or wire is damaged, it must be exchanged by the supplier, its agent or other similar qualified personnel to avoid dangers.